

PROPOSED CWMTF CONSERVATION DECLARATIONS

COUNTY PARCEL	PARCEL NUMBER	DECLARATION AREA	TOTAL PARCEL AREA
A	20722198	0.865 ACRES	31.690 ACRES
B	20712163	0.334 ACRES	0.974 ACRES
C	20712164	0.534 ACRES	1.147 ACRES
D	20707105	7.838 ACRES	21.924 ACRES
E	20706203	8.782 ACRES	44.398 ACRES
TOTAL AREA		18.353 ACRES	100.133 ACRES

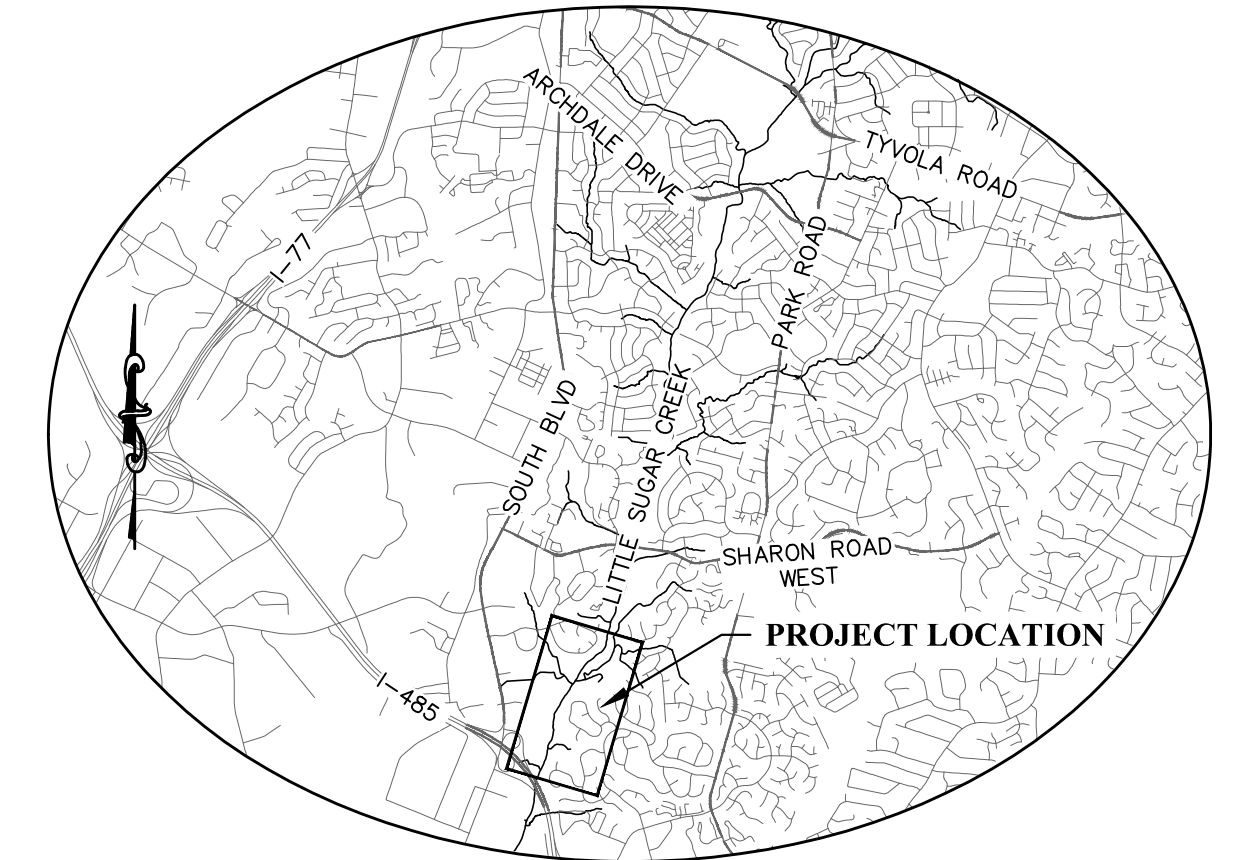

VICINITY MAP
NTS

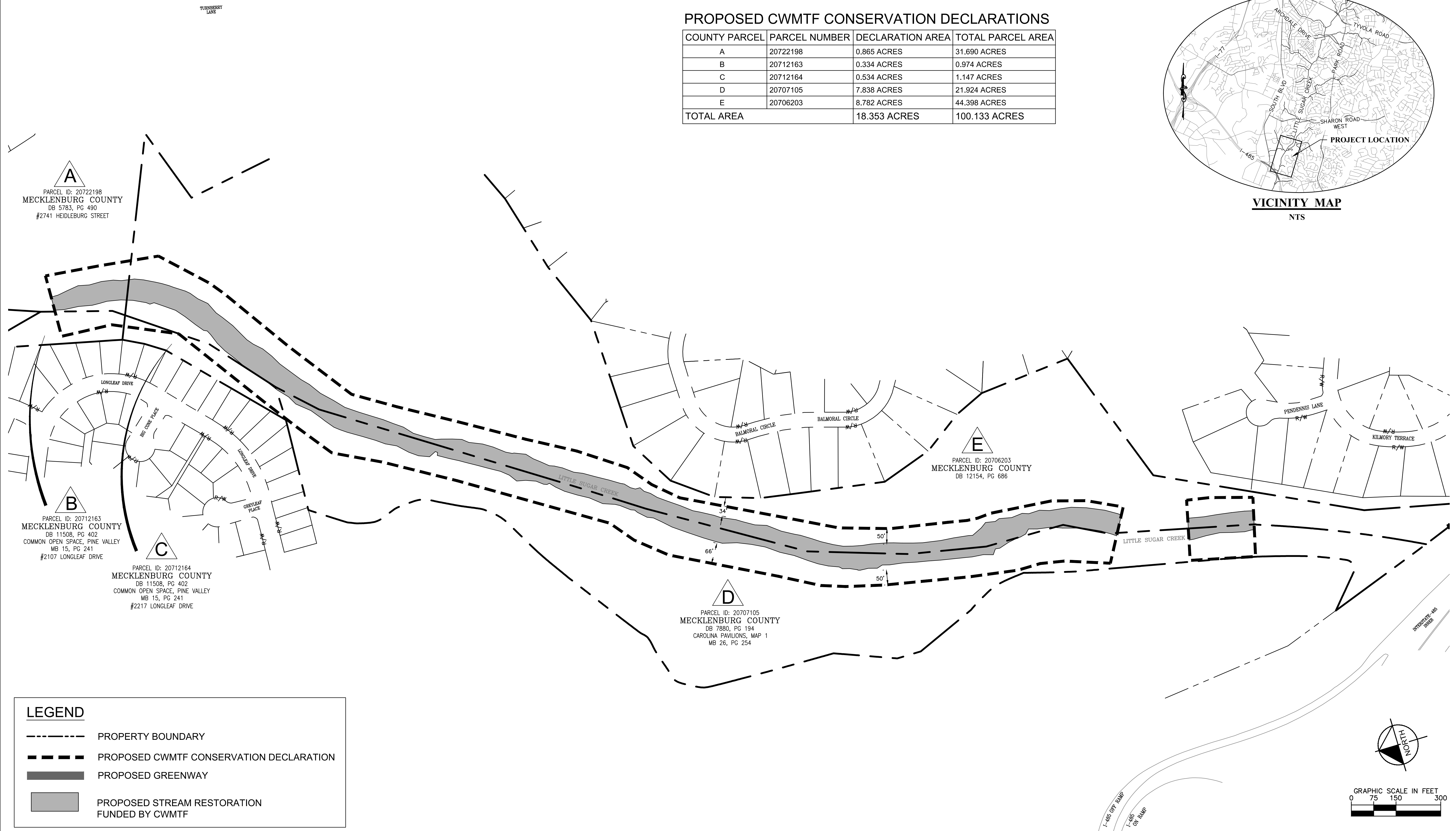

LEGEND

- PROPERTY BOUNDARY
- PROPOSED CWMTF CONSERVATION DECLARATION
- PROPOSED GREENWAY
- PROPOSED STREAM RESTORATION FUNDED BY CWMTF

K:\CHL_PR\1015235_Mecklenburg_County\028_LSC_Stream_Tyvola to I_485\Coord\ExhibitA\2017-02-17_CWTF_Easement_ExhibitA\SC_Accordie_CWTF_Easement.dwg

THIS DOCUMENT, TOGETHER WITH THE CONCEPTS AND DESIGNS PRESENTED HEREIN, AS AN INSTRUMENT OF SERVICE, IS INTENDED ONLY FOR THE SPECIFIC PURPOSE AND CLIENT FOR WHICH IT WAS PREPARED. REUSE OF AND IMPROPER RELIANCE ON THIS DOCUMENT WITHOUT WRITTEN AUTHORIZATION AND ADAPTATION BY KIMLEY-HORN AND ASSOCIATES, INC. SHALL BE WITHOUT LIABILITY TO KIMLEY-HORN AND ASSOCIATES, INC.