

**FINAL ASSESSMENT ROLL RESOLUTION
STREET LIGHTING ASSESSMENT PROJECT
CARDINAL WOODS SUBDIVISION AND CARDINAL WOODS ESTATE
OPERATION COSTS FY 2013**

WHEREAS, the Mecklenburg Board of County Commissioners has adopted a street lighting assessment program pursuant to North Carolina law; and

WHEREAS, twenty-four acorn street lighting fixtures have been installed and are being operated on streets within the Cardinal Woods Subdivision and Cardinal Woods Estate; and

WHEREAS, the Mecklenburg Board of County Commissioners adopted a Final Assessment Resolution on this project on October 20, 1998, approving the project and requesting that Duke Power Company install and operate the acorn street lighting fixtures on the streets in the Cardinal Woods Subdivision and Cardinal Woods Estate, and providing that the monthly charges would be paid to Duke Power Company by Mecklenburg County, and that the operating costs would be assessed to the property owners by Mecklenburg County; and

WHEREAS, Mecklenburg County has paid a total of \$5,570.25 to Duke Power Company for the monthly operation costs incurred for these street lighting fixtures in the Cardinal Woods Subdivision and Cardinal Woods Estate during the 2013 Fiscal Year and has incurred \$300 in legal and other costs for a total of \$5,870.25 spent for the operation of these acorn street lighting fixtures in the Cardinal Woods Subdivision and Cardinal Woods Estate during the 2013 Fiscal Year; and

WHEREAS, the basis for assessment will be 100% of the property owner's share of the total costs to operate these street lighting fixtures during the 2013 Fiscal Year plus other costs as described in Section 153A-193 of the General Statutes of North Carolina, said total cost to be apportioned equally to each parcel of land on

the streets in the Cardinal Woods Subdivision and Cardinal Woods Estate where the acorn street lighting fixtures are located; and

WHEREAS, the proposed terms of payment of the assessment are such that each property owner must pay the total per lot share upon receipt of an assessment from Mecklenburg County; and

WHEREAS, the method of payment for each property owner's portion of the cost of said operation must be paid by direct payment to Mecklenburg County; and

WHEREAS, the Mecklenburg County Land Use and Environmental Services Agency has prepared the Final Assessment Roll and a map showing each lot assessed, the basis for assessment, the amount assessed against each lot and the name of the owner of each lot as shown on the Mecklenburg County tax record, which Final Assessment Roll and map are attached hereto and incorporated herein by reference; and

WHEREAS, after notice was duly given, a public hearing was held on December 3, 2013 at 6:30 p.m. for the purpose of confirmation, modification, or annulment of the Preliminary Assessment Roll; and

WHEREAS, there being no changes or annulment made of the Preliminary Assessment Roll, the same is hereby confirmed by this resolution; now, therefore be it

RESOLVED that the Mecklenburg Board of County Commissioners does adopt this Final Assessment Roll Resolution on the Street Lighting Assessment Project for the operation of the street lighting fixtures during the 2013 Fiscal Year in the Cardinal Woods Subdivision and Cardinal Woods Estate, and requests the Mecklenburg County Land Use & Environmental Services Agency to prepare the necessary documents for transmittal to the County Tax Collector's Office to provide for the collection from the

property owners for the cost of the operation of the street lighting fixtures during the 2013 Fiscal Year which is \$5,870.25.

ADOPTED ON THE _____ DAY OF _____ 2013.

Clerk to the Mecklenburg Board of
County Commissioners

APPROVED AS TO FORM:

County Attorney

**Cardinal Woods Subdivision and
Cardinal Woods Estate**
SL 98 - 04
Final
Assessment Roll for FY 2013

PARCEL	OWNER1	OWNER2	SITUS_ADDRESS	MAILING_ADDRESS	CITY_STATE	LEGAL_DESC	COST
22301301	Glenda I Murray	Richard W Jr Murray	12507 Cardinal Woods Dr	12507 Cardinal Woods Dr	Pineville NC 28134	L1 B2 M29-596	\$ 28.98
22301302	Bennie Sullivan	Sy Sullivan	12511 Cardinal Woods Dr	12511 Cardinal Woods Dr	Pineville NC 28134	L2 B2 M29-596	\$ 28.98
22301303	Arto Karadjian	Mariam Karadjian	12515 Cardinal Woods Dr	12515 Cardinal Woods Dr	Pineville NC 28134	L3 B2 M29-596	\$ 28.98
22301304	Steven R Wimmer	Cynthia M Wimmer	12519 Cardinal Woods Dr	12519 Cardinal Woods Dr	Pineville NC 28134	L4 B2 M29-596	\$ 28.98
22301305	Channeh Comma		12523 Cardinal Woods Dr	12523 Cardinal Woods Dr	Pineville NC 28134	L5 B2 M29-596	\$ 28.98
22301306	Linda M Funderburk		12529 Cardinal Woods Dr	12529 Cardinal Woods Dr	Pineville NC 28134	L6 B2 M29-596	\$ 28.98
22301307	Eugene S Jr Majewski	Linda J Majewski (H/W)	12535 Cardinal Woods Dr	12535 Cardinal Woods Dr	Pineville NC 28134	L7 B2 M29-596	\$ 28.98
22301308	Micheal Poirer	Kirsten Poirer	12545 Cardinal Woods Dr	12545 Cardinal Woods Dr	Pineville NC 28134	L8 B2 M29-596	\$ 28.98
22301309	Ernest P Girard	Gloria M Girard	12605 Cardinal Woods Dr	12605 Cardinal Woods Dr	Mathews NC 28104	L9 B2 M29-596	\$ 28.98
22301310	Alantic Palisades Investment G		12611 Cardinal Woods Dr	13663 Providence Rd #182	Pineville NC 28134	L10 B2 M29-596	\$ 28.98
22301311	Nhung Le Nguyen	Hau Nguyen	12617 Cardinal Woods Dr	12617 Cardinal Woods Dr	Pineville NC 28134	L11 B2 M29-596	\$ 28.98
22301312	Bridgett Anne(F/T) Woods		12625 Cardinal Woods Dr	12625 Cardinal Woods Dr	Pineville NC 28134	L12 B2 M29-596	\$ 28.98
22301313	Lydia Nabors		12633 Cardinal Woods Dr	12633 Cardinal Woods Dr	Pineville NC 28134	L13 B2 M30-403	\$ 28.98
22301314	Chadwick E Best	Cynthia M Best	12639 Cardinal Woods Dr	12639 Cardinal Woods Dr	Pineville NC 28134	L14 B2 M30-403	\$ 28.98
22301315	Ricky Carlson		13713 Bluffton Ct	13713 Bluffton Ct	Pineville NC 28134	L15 B2 M30-403	\$ 28.98
22301316	Richard T Fenton	Ashley D Fenton	13721 Bluffton Ct	13721 Bluffton Ct	Pineville NC 28134	L16 B2 M30-403	\$ 28.98
22301317	Yasushi Osaka	Sheila Widner Osaka	13731 Bluffton Ct	13731 Bluffton Ct	Pineville NC 28134	L17 B2 M30-403	\$ 28.98
22301318	Angkana Lewchalermwong		13735 Bluffton Ct	13735 Bluffton Ct	Pineville NC 28134	L18 B2 M30-403	\$ 28.98
22301319	Tina Peake Adams		13739 Bluffton Ct	13739 Bluffton Ct	Pineville NC 28134	L19 B2 M30-403	\$ 28.98
22301320	Sra Mccormick		13742 Bluffton Ct	13742 Bluffton Ct	Pineville NC 28134	L20 B2 M30-403	\$ 28.98
22301321	Blake George Medica	Anna E Medica	13738 Bluffton Ct	13738 Bluffton Ct	Pineville NC 28134	L21 B2 M30-403	\$ 28.98
22301322	The Clifford W Pulkas	Turst Mary C Pulkas Revocable Livin	13734 Bluffton Ct	13734 Bluffton Ct	Pineville NC 28134	L22 B2 M30-403	\$ 28.98
22301323	Kishor T Patel	Chrika Patel	13730 Bluffton Ct	13730 Bluffton Ct	Malibu CA 90265	L23 B2 M30-403	\$ 28.98
22301324	Ah4R-Nc3 Llc		13724 Bluffton Ct	22917 Pacific Coast Highway Ste 300	Malibu CA 90265	L24 B2 M30-823	\$ 28.98
22301325	Ah4R1Nc Llc		13718 Bluffton Ct	22917 Pacific Coast Highway Ste 300	Malibu CA 90265	L25 B2 M30-403	\$ 28.98
22301326	Robert M Hussey	Ginger H Hussey	13712 Bluffton Ct	13712 Bluffton Ct	Pineville NC 28134	L26 B2 M30-823	\$ 28.98
22301327	Jeffery G Meyers	Kathryn A Meyers	13708 Bluffton Ct	13708 Bluffton Ct	Pineville NC 28134	L27 B2 M30-403	\$ 28.98
22301328	John M Mark	Carol Lee Mark	13702 Bluffton Ct	13702 Bluffton Ct	Pineville NC 28134	L28 B2 M30-823	\$ 28.98
22301338	Daniel A Gallegos		12648 Cardinal Woods Dr	12648 Cardinal Woods Dr	Pineville NC 28134	L38 B2 M33-905	\$ 28.98
22301339	Benjamin N Igwe	Sonya Igwe	12646 Cardinal Woods Dr	12646 Cardinal Woods Dr	Pineville NC 28134	L39 B2 M30-403	\$ 28.98
22301340	Mark D Royer	Susan R Royer	12642 Cardinal Woods Dr	12642 Cardinal Woods Dr	Pineville NC 28134	L40 B2 M30-403	\$ 28.98
22301341	Patrick C Cox	Kathry M Cox	12638 Cardinal Woods Dr	12638 Cardinal Woods Dr	Pineville NC 28134	L41 B2 M30-403	\$ 28.98
22301342	Mark A Simpson	Jennifer S Simpson	12632 Cardinal Woods Dr	12632 Cardinal Woods Dr	Pineville NC 28134	L42 B2 M30-403	\$ 28.98
22301343	Peter Fellows	Catherine Fellows	12628 Cardinal Woods Dr	12628 Cardinal Woods Dr	Charlotte NC 28134	L43 B2 M30-403	\$ 28.98
22301344	Allison N Rost	Matthew D Rost	12624 Cardinal Woods Dr	12624 Cardinal Woods Dr	Pineville NC 28134	L44 B2 M29-596	\$ 28.98
22301345	James M Helms	Ruth M Helms	12620 Cardinal Woods Dr	12620 Cardinal Woods Dr	Charlotte NC 28277	L45 B2 M29-596	\$ 28.98
22301346	Nilesh B Desai	Jollyben Desai	12614 Cardinal Woods Dr	12614 Cardinal Woods Dr	Pineville NC 28134	L46 B2 M29-596	\$ 28.98
22301347	James W Reynolds	C/O Ken Murphy	13630 Edgetree Dr	14708 Bridal Trace Ln	Charlotte NC 28210	L47 B2 M29-596	\$ 28.98
22301348	Mamdouh B Soliman	Emilie A Soliman	13622 Edgetree Dr	2008 Archdale Dr	Pineville NC 28134	L48 B2 M29-596	\$ 28.98
22301349	Nancy Moseley Proietti	Richard William Proietti	13612 Edgetree Dr	13612 Edgetree Dr	Pineville NC 28134	L49 B2 M31-321	\$ 28.98
22301350	Micheal E, Jr. Burch	Kathryn B. Burch	13604 Edgetree Dr	13604 Edgetree Dr	Pineville NC 28134	L50 B2 M31-321	\$ 28.98
22301351	Thomas J Fahey	Teri-Lea C Fahey (H/W)	12107 Autumn Winds Ln	12107 Autumn Winds Ln	Pineville NC 28134	L51 B2 M31-457	\$ 28.98
22301352	Leroy Weaver	Maria Weaver	12113 Autumn Winds Ln	12113 Autumn Winds Ln	Pineville NC 28134	L52 B2 M31-457	\$ 28.98
22301353	Robert D Poole		12119 Autumn Winds Ln	12119 Autumn Winds Ln	Pineville NC 28134	L53 B2 M31-321	\$ 28.98
22301354	Vesselina Ratcheva		12127 Autumn Winds Ln	12127 Autumn Winds Ln	Pineville NC 28134	L54 B2 M31-457	\$ 28.98
22301355	Sidney Floyd Stanley		12133 Autumn Winds Ln	12133 Autumn Winds Ln	Pineville NC 28134	L55 B2 M31-321	\$ 28.98
22301356	Jorge M Vazquez	Maria Lorelena Padilla Ramirez	12139 Autumn Winds Ln	12139 Autumn Winds Ln	Pineville NC 28134	L56 B2 M31-457	\$ 28.98
22301357	William A Sutherland	Angel Kay Sutherland	12145 Autumn Winds Ln	12145 Autumn Winds Ln	Pineville NC 28134	L57 B2 M31-457	\$ 28.98
22301358	Aaron Justin Olenik		12151 Autumn Winds Ln	12151 Autumn Winds Ln	Pineville NC 28134	L58 B2 M31-457	\$ 28.98
22301359	Jeffrey Bean		12155 Autumn Winds Ln	12155 Autumn Winds Ln	Pineville NC 28134	L59 B2 M31-457	\$ 28.98
22301360	Anthony T Mazzone		12159 Autumn Winds Ln	12159 Autumn Winds Ln	Pineville NC 28134	L60 B2 M31-457	\$ 28.98
22301361	Kimberly T Martin	Scott M Martin	12156 Autumn Winds Ln	12156 Autumn Winds Ln	Pineville NC 28134	L61 B2 M31-457	\$ 28.98
22301362	Fred Ramsey	Susan Ramsey	12152 Autumn Winds Ln	12152 Autumn Winds Ln	Pineville NC 28134	L62 B2 M31-321	\$ 28.98
22301363	Redino Rezzoli		13528 Honeytree Ln	13528 Honeytree Ln	Pineville NC 28134	L63 B2 M31-321	\$ 28.98
22301364	Janice M Harker	John E Harker	13522 Honeytree Ln	13522 Honeytree Ln	Pineville NC 28134	L64 B2 M31-457	\$ 28.98
22301365	Monica C Abad	Jose L Abad	13516 Honeytree Ln	13516 Honeytree Ln	Pineville NC 28134	L65 B2 M31-457	\$ 28.98
22301366	Darrin P Theriault	Heather E Theriault	13508 Honeytree Ln	13508 Honeytree Ln	Pineville NC 28134	L66 B2 M31-457	\$ 28.98
22301367	Boyce Boya Sr Friday	Marilyn T Friday	13500 Honeytree Ln	13500 Honeytree Ln	Pineville NC 28134	L67 B2 M31-457	\$ 28.98
22301368	Mary C Doby		13438 Honeytree Ln	13438 Honeytree Ln	Pineville NC 28134	L68 B2 M31-321	\$ 28.98
22301369	Sean Sojack	Kelly Sojack	12215 Pinegate Ct	12215 Pinegate Ct	Brooklyn NY 11238	L69 B2 M31-457	\$ 28.98
22301370	Eric B Clarke	Faye N Clarke	12219 Pinegate Ct	495 Park Pl	Pineville NC 28134	L70 B2 M31-457	\$ 28.98

**Cardinal Woods Subdivision and
Cardinal Woods Estate**
SL 98 - 04
Final
Assessment Roll for FY 2013

PARCEL	OWNER1	OWNER2	SITUS_ADDRESS	MAILING_ADDRESS	CITY_STATE	LEGAL_DESC	COST
22301371	Leopoldo Gonzalez	Lusmy Zavaleta Gonzalez	12223 Pinegate Ct	12223 Pinegate Ct	Pineville NC 28134	L71 B2 M31-457	\$ 28.98
22301372	Sra Elaine Brake		12224 Pinegate Ct	1224 Pinegate Ct	Pineville NC 28134	L72 B2 M31-457	\$ 28.98
22301373	Jon Langborgh	Jennifer Langborgh	12220 Pinegate Ct	12220 Pinegate Ct	Pineville NC 28134	L73 B2 M32-711	\$ 28.98
22301374	Manuel P Rosas	Maria L Rosas	12216 Pinegate Ct	12216 Pinegates Ct	Pineville NC 28134	L74 B2 M31-457	\$ 28.98
22301375	Jamey R Bowser		12210 Pinegate Ct	12210 Pinegate Ct	Charlotte NC 28269	L75 B2 M31-457	\$ 28.98
22301376	Thr North Carolina II Lp		12204 Pinegate Ct	9300 Harris Corners Py #440	Pineville NC 28134	L76 B2 M31-457	\$ 28.98
22301377	Thomas M Civitello	Ellen L Civitello	13416 Honeytree Ln	13416 Honeytree Ln	Pineville NC 28134	L77 B2 M31-457	\$ 28.98
22301378	Alva Timothy Redden	Yona Jacob Redden	13408 Honeytree Ln	13404 Honeytree Ln	Pineville NC 28134	L78 B2 M31-457	\$ 28.98
22301379	Alva T Redden	Yona S Jacob-Redden	13404 Honeytree Ln	13404 Honeytree Ln	Pineville NC 28134	L79 B2 M31-457	\$ 28.98
22301380	Ernest li Patton		13400 Honeytree Ln	13400 Honeytree Ln	Pineville NC 28134	L80 B2 M31-457	\$ 28.98
22301381	Ricardo P Maset		13405 Honeytree Ln	13405 Honeytree Ln	Pineville NC 28134	L81 B2 M31-457	\$ 28.98
22301382	Jason Lenkiewicz	Catherine C Lenkiewicz	13411 Honeytree Ln	13411 Honeytree Ln	Pineville NC 28134	L82 B2 M31-457	\$ 28.98
22301383	Matthew W Burrough	Megan Burrough	13417 Honeytree Ln	13417 Honeytree Ln	Charlotte NC 28277	L83 B2 M31-457	\$ 28.98
22301384	Daniel L Szudzik	Elizabeth A Szudzik	13423 Honeytree Ln	6732 B Bevington Ridge Rd	Pineville NC 28134	L84 B2 M31-457	\$ 28.98
22301385	Robert E Jr Forth	Ty B Forth	13429 Honeytree Ln	13429 Honey Tree Ln	Pineville NC 28134	L85 B2 M31-457	\$ 28.98
22301386	Sibel A Caba		13435 Honeytree Ln	13435 Honeytree Ln	Pineville NC 28134-9136	L86 B2 M31-457	\$ 28.98
22301387	Carolyn J Norton		13441 Honeytree Ln	13441 Honeytree Ln	Pineville NC 28134	L87 B2 M31-457	\$ 28.98
22301416	Gregory A Ishmael	Brenda P Ishmael	13330 Edgetree Dr	13330 Edgetree Dr	Pineville NC 28134	L23 B2 M33-831	\$ 28.98
22301417	Chinmay P Nadkarni	Devarki Nadkarni	13324 Edgetree Dr	13324 Edgetree Dr	Pineville NC 28134	L22 B2 M33-831	\$ 28.98
22301418	Colleen S Briggs	William S Briggs	13318 Edgetree Dr	13318 Edgetree Dr	Pineville NC 28134	L21 B2 M33-831	\$ 28.98
22301419	Philip Call		13312 Edgetree Dr	13312 Edgetree Dr	Pineville NC 28134	L20 B2 M33-831	\$ 28.98
22301420	Viola M Russell	James A Russell	13306 Edgetree Dr	13306 Edgetree Dr0	Pineville NC 28134	L19 B2 M33-831	\$ 28.98
22301421	Deborah Zahn		13305 Edgetree Dr	13305 Edgetree Dr	Pineville NC 28134	L18 B2 M33-831	\$ 28.98
22301423	Margret I Mciver		13315 Edgetree Dr	13315 Edgetree Dr	Pineville NC 28134	L16 B2 M33-831	\$ 28.98
22301424	Shana Robertson	Matt Robertson	13321 Edgetree Dr	13321 Edgetree Dr	Fort Mill SC 29707-6202	L15 B2 M33-831	\$ 28.98
22301425	Yusuf A. Javeri	Sabira Javeri	13327 Edgetree Dr	22016 Preswick Dr	Pineville NC 28134	L14 B2 M33-831	\$ 28.98
22301426	Tai Chambers		13333 Edgetree Dr	13333 Edgetree Dr	Pineville NC 28134	L13 B2 M33-831	\$ 28.98
22301427	Barry E Blair		13403 Edgetree Dr	13403 Edgetree Dr	Pineville NC 28134	L12 B2 M33-831	\$ 28.98
22301428	Fred R Torres	Jennifer M Torres	13407 Edgetree Dr	13407 Edgetree Dr	Pineville NC 28134	L11 B2 M33-831	\$ 28.98
22301429	Cynthia F Lee	Feffrey T Lee	13413 Edgetree Dr	13413 Edgetree Dr	Pineville NC 28134	L10 B2 M33-831	\$ 28.98
22301430	Damion L Jordan		13419 Edgetree Dr	13419 Edgetree Dr	Ft Mill SC 29707	L9 B2 M33-831	\$ 28.98
22301431	Favio Intriago		13425 Edgetree Dr	6047 Arundale Ln	Pineville NC 28134	L8 B2 M33-831	\$ 28.98
22301432	Irish G Holl		13433 Edgetree Dr	13433 Edgetree Dr	Pineville NC 28134	L7 B2 M33-831	\$ 28.98
22301433	Jessica Vils		13443 Edgetree Dr	13443 Edgetree Dr	Pineville NC 28134	L6 B2 M33-831	\$ 28.98
22301434	Nikolay A Ganchenko		13449 Edgetree Dr	13449 Edgetree Dr	Pineville NC 28134	L5 B2 M33-831	\$ 28.98
22301436	Lee Stuart Bodner	Robin Rowl Bodner	13309 Edgetree Dr	13309 Edgetree Dr	Pineville NC 28134	L17 B2 M33-831	\$ 28.98
22301437	Harry W Jr Philips		12030 Harmon Ln	12030 Harmon Ln	Pineville NC 28134	L53 B1 M36-33	\$ 28.98
22301438	Philip R Wainscott	Marilyn S Wainscott	12022 Harmon Ln	12022 Harmon Ln	Fort Mill SC 29708	L52 B1 M36-33	\$ 28.98
22301439	Rhonda Ardelean		12016 Harmon Ln	1646 West Highway 160#8141	Pineville NC 28134	L51 B1 M36-33	\$ 28.98
22301440	Alva T Redden	Yona S Jacob-Redden	12008 Harmon Ln	13404 Honeytree Ln	Pineville NC 287134	L50 B1 M36-33	\$ 28.98
22301441	John G Jr Gardiner	Christine Ann Gardiner	12002 Harmon Ln	12002 Harmon Ln	Waxhaw NC 28173	L49 B1 M36-33	\$ 28.98
22301442	Msm Properties Llc		11944 Harmon Ln	9105 Man Of War Dr	Pineville NC 28134	L48 B1 M36-33	\$ 28.98
22301443	Johnson C Kuriakose	Shiji Johnson	11938 Harmon Ln	11938 Harmon Ln	Pineville NC 28134	L47 B1 M36-33	\$ 28.98
22301444	David H Hollifield	Jayne J Hollifield	11932 Harmon Ln	11932 Harmon Ln	Malibu CA 90265	L46 B1 M36-33	\$ 28.98
22301445	Llc American Home 4 Rent Properties		11928 Harmon Ln	23815 Stuart Ranch Rd Ste 302	Charlotte NC 28226	L45 B1 M36-33	\$ 28.98
22301446	Martin Rissmann		11922 Harmon Ln	5033 Morrowick Rd	Pineville NC 28134	L44 B1 M36-33	\$ 28.98
22301447	Christopher C Wilson	Gail S Wilson	11918 Harmon Ln	11918 Harmon Ln	Pineville NC 28134	L43 B1 M36-33	\$ 28.98
22301448	Timothy R Shenise	Enid N Shenise	11912 Harmon Ln	11912 Harmon Ln	Charlotte NC 28134	L42 B1 M36-33	\$ 28.98
22301449	Vivek Sinha	Shweta Sinha	11906 Harmon Ln	11906 Harmon Ln	Pineville NC 28134	L41 B1 M36-33	\$ 28.98
22301450	Paul C D Alborn	Teresa S D Alborn	11902 Harmon Ln	11902 Harmon Ln	Pineville NC 28134	L40 B1 M36-33	\$ 28.98
22301451	Heather R Rose	Christopher C Rose	11905 Harmon Ln	11905 Harmon Ln	Pineville NC 28134	L39 B1 M36-33	\$ 28.98
22301452	Michael R Guthrie	Shellina M Guthrie	11911 Harmon Ln	11911 Harmon Ln	Pineville NC 28134	L38 B1 M36-33	\$ 28.98
22301453	Brian A Anderson	Jolundra S Anderson	11917 Harmon Ln	11917 Harmon Ln	Pineville NC 28134	L37 B1 M36-33	\$ 28.98
22301454	Patrick Savago	Briana Savago	11925 Harmon Ln	11925 Harmon Ln	Charlotte NC 28134	L36 B1 M36-33	\$ 28.98
22301455	Stacy E Gatto	Bryan Carter	11929 Harmon Ln	11929 Harmon Ln	Pineville NC 28134	L35 B1 M36-33	\$ 28.98
22301456	Thomas M Jr Shuler		11933 Harmon Ln	11933 Harmon Ln	Pineville NC 28134	L34 B1 M36-33	\$ 28.98
22301457	Janet Dickerson Richard		11937 Harmon Ln	11937 Harmon Ln	Paramus NJ 07652-3741	L33 B1 M36-33	\$ 28.98
22301458	Aviv Efrat		11941 Harmon Ln	96 Nichols Dr	Pineville NC 28134	L32 B1 M36-33	\$ 28.98
22301459	Kevin Hensley	Latisha Hensley	11945 Harmon Ln	11945 Harmon Ln	Pineville NC 28134	L31 B1 M36-33	\$ 28.98
22301460	Louis C Rosser	Audra P Rosser	13316 Alex Mill Dr	13316 Alex Mill Dr	Pineville NC 28134	L30 B1 M37-75	\$ 28.98
22301461	Khalid A Alnabulsi		13304 Alex Mill Dr	13304 Alex Mill Drive	Pineville NC 28134	L29 B1 M37-75	\$ 28.98

**Cardinal Woods Subdivision and
Cardinal Woods Estate**
SL 98 - 04
Final
Assessment Roll for FY 2013

PARCEL	OWNER1	OWNER2	SITUS_ADDRESS	MAILING_ADDRESS	CITY_STATE	LEGAL_DESC	COST
22301462	Loan Ta Terry	Michael A Terry	13230 Alex Mill Dr	13230 Alex Mill Dr	Pineville NC 28134	L28 B1 M37-75	\$ 28.98
22301463	John R Wappes	Alyssa J Wappes	13220 Alex Mill Dr	13222 Alex Mill Dr	Pineville NC 28134	L27 B1 M37-75	\$ 28.98
22301464	Brian A Davis	Linda K Davis	13218 Alex Mill Dr	13218 Alex Mill Dr	Pineville NC 28134	L26 B1 M37-75	\$ 28.98
22301465	Laura T Burba	Roger F Burba	13214 Alex Mill Dr	13214 Alex Mill Dr	Pineville NC 28134	L25 B1 M37-75	\$ 28.98
22301466	Robert W Bostwick	Heather A Lasher	13208 Alex Mill Dr	13208 Alex Mill Dr	Pineville NC 28134	L24 B1 M37-75	\$ 28.98
22301467	Michael D Ward	Lynne M Ward	13202 Alex Mill Dr	13202 Alex Mill Dr	Pineville NC 28134	L23 B1 M37-75	\$ 28.98
22301468	Lisa J Welch	Aaron M Welch	13209 Alex Mill Dr	13209 Alex Mill Dr	Pineville NC 28134	L22 B1 M37-75	\$ 28.98
22301469	Michael L Jones	Michelle L Jones	13215 Alex Mill Dr	13215 Alex Mill Dr	Pineville NC 28134	L21 B1 M37-75	\$ 28.98
22301470	Maynak Patel		13223 Alex Mill Dr	13223 Alex Mill Dr	Pineville NC 28134	L20 B1 M37-75	\$ 28.98
22301471	Paul F Skinner	Leslie J Little	13229 Alex Mill Dr	13229 Alex Mill Dr	Pineville NC 28134	L19 B1 M37-75	\$ 28.98
22301501	Douglas R Sluder	Anne F Sluder	13503 Honeytree Ln	13503 Honeytree Lane	Pineville NC 28134	L10 B3 M31-321	\$ 28.98
22301502	Lynn M Douglas	Stacey M Douglas (H/W)	13507 Honeytree Ln	13507 Honeytree Ln	Pineville NC 28134	L9 B3 M31-457	\$ 28.98
22301503	Richard N Purvis	Linda L Purvis	13511 Honeytree Ln	13511 Honeytree Ln	Pineville NC 28134	L8 B3 M31-457	\$ 28.98
22301504	David H Toe	Darlean C Toe	13517 Honeytree Ln	13517 Honeytree Ln	Pineville NC 28134-9237	L7 B3 M31-457	\$ 28.98
22301505	Scott Alan Robinson	Jaime Henkels Robinson	12134 Autumn Winds Ln	12134 Autumn Winds Ln	Pineville NC 28134	L6 B3 M31-321	\$ 28.98
22301506	Gregory S Myers	Susan A Myers	12128 Autumn Winds Ln	12128 Autumn Winds Ln	Pineville NC 28134	L5 B3 M31-321	\$ 28.98
22301507	Robert Bonds	Carol Bonds	12122 Autumn Winds Ln	12122 Autumn Winds Ln	Charlotte NC 28134	L4 B3 M31-321	\$ 28.98
22301508	Rall B Barber	Meggan K Barber	12118 Autumn Winds Ln	12118 Autumn Winds Ln	Pineville NC 28134	L3 B3 M31-321	\$ 28.98
22301509	Brian E Beglin	Caroline R A Beglin	12112 Autumn Winds Ln	12112 Autumn Winds Ln	Pineville NC 28134	L2 B3 M31-457	\$ 28.98
22301510	James D Macrae	Nancy J Mcrae	13538 Edgetree Dr	13538 Edgetree Dr	Pineville NC 28134	L1 B3 M31-457	\$ 28.98
22301511	Dharmesh Patel	Harnisha Patel	13526 Edgetree Dr	13526 Edgetree Dr	Pineville NC 28134	L32 B2 M33-831	\$ 28.98
22301512	Ali Patsiyev	Lala Gasanova	13504 Edgetree Dr	13504 Edgetree Dr	Pineville NC 28134	L31 B3 M33-831	\$ 28.98
22301513	Alan L Vaugh	Jean L Vaugh	13450 Edgetree Dr	13450 Edgetree Dr	Pineville NC 28134	L30 B3 M33-831	\$ 28.98
22301514	Joseph W Rumsey	Margarita S Rumsey	13444 Edgetree Dr	13444 Edgetree Dr	Pineville NC 28134	L29 B3 M33-831	\$ 28.98
22301515	Stephen M Murnane	Annette M Murnane	13438 Edgetree Dr	13438 Edgetree Dr	Pineville NC 28134	L28 B3 M33-831	\$ 28.98
22301516	Brian J Rasmussen		13432 Edgetree Dr	13432 Edgetree Dr	Pineville NC 28134	L27 B3 M33-831	\$ 28.98
22301517	Salim Punjani		13426 Edgetree Dr	13426 Edgetree Dr	Pineville NC 28134	L26 B3 M33-831	\$ 28.98
22301518	Richard Foster		13420 Edgetree Dr	13420 Edgetree Dr	Pineville NC 28134	L25 B3 M33-831	\$ 28.98
22301519	Lorie Ann Sanhueza	Luis Sanhueza	13410 Edgetree Dr	13410 Edgetree Dr	Pineville NC 28134	L24 B3 M33-831	\$ 28.98
22301601	Eric M Madden	Melissa J Madden	11808 Jacobs Ridge Ct	11808 Jacobs Ridge Ct	Pineville NC 28134	L18 B1 M37-75	\$ 28.98
22301602	Ramadevi S Nair		11804 Jacobs Ridge Ct	11804 Jacobs Ridge Ct	Pineville NC 28134	L17 B1 M37-75	\$ 28.98
22301603	Lynda Henry Hayes		11805 Jacobs Ridge Ct	11805 Jacobs Ridge Ct	Pineville NC 28134	L16 B1 M37-75	\$ 28.98
22301604	April Jacobs		11809 Jacobs Ridge Ct	11809 Jacobs Ridge Ct	Pineville NC 28134	L15 B1 M37-75	\$ 28.98
22301606	Robert D Kelly		13303 Alex Mill Dr	13303 Alex Mill Dr	Pineville NC 28134	L14 B1 M37-75	\$ 28.98
22301607	Manan A Sheth	Ashok T Sheth	13307 Alex Mill Dr	13307 Alex Mill Dr	Pineville NC 28134	L13 B1 M37-75	\$ 28.98
22301608	Robert Baer	Heather Baer	13311 Alex Mill Dr	13311 Alex Mill Dr	Pineville NC 28134	L12 B1 M37-75	\$ 28.98
22301609	Sharon C Williams		13317 Alex Mill Dr	13317 Alex Mill Dr	Pineville NC 28134	L11 B1 M37-75	\$ 28.98
22301610	Sashi S Amatya	Asha S Amatya	13323 Alex Mill Dr	13323 Alex Mill Dr	Pineville NC 28134	L10 B1 M37-75	\$ 28.98
22301611	Andre D Carpenter	April C Carpenter	13329 Alex Mill Dr	13329 Alex Mill Dr	Pineville NC 28134	L9 B1 M37-75	\$ 28.98
22301612	Elsamma Thomas	George V Thomas	13335 Alex Mill Dr	13335 Alex Mill Dr	Rutl VT 05701	L8 B1 M37-75	\$ 28.98
22301613	Frederick W Borger	Pamela Devost	12007 Harmon Ln	401 West Ridge Terrace	Pineville NC 28134	L7 B1 M36-33	\$ 28.98
22301614	Joni Lee Feidler		12015 Harmon Ln	12015 Harmon Ln	Pineville NC 28134	L6 B1 M36-33	\$ 28.98
22301615	Si-Jeun J Armbruster	Brad A Armbruster	12019 Harmon Ln	12019 Harmon Ln	Pineville NC 28134	L5 B1 M36-33	\$ 28.98
22301616	William Merkel	Kassra Merkel	12025 Harmon Ln	12025 Harmon Ln	Pineville NC 28134	L4 B1 M37-75	\$ 28.98
22301617	Matthew Gregory Kern	Aimee Marie Kern	11622 Rudolph Place Dr	11622 Rudolph Place Dr	Pineville NC 28134	L3 B1 M37-75	\$ 28.98
22301618	Rebecca Mulbah	Yanquae Mulbah	11616 Rudolph Place Dr	11616 Rudolph Place Dr	Pineville NC 28134	L2 B1 M37-75	\$ 28.98
22301619	Jesse A Kleinmeier		11612 Rudolph Place Dr	11612 Rudolph Place Dr	Pineville NC 28134	L1 B1 M37-75	\$ 28.98
22301702	Brian F Jones	Stacey S Jones	11611 Rudolph Place Dr	11611 Rudolph Place Dr	Pineville NC 28134	L56 B1 M37-75	\$ 28.98
22301703	Robert Palmer	Amy Palmer	11615 Rudolph Place Dr	11615 Rudolph Place Dr	Pineville NC 28134	L55 B1 M37-75	\$ 28.98
22301704	Reginald Ferrell	Teresa M Ferrell	11621 Rudolph Place Dr	11621 Rudolph Place Dr	Pineville NC 28134	L54 B1 M37-75	\$ 28.98
22301705	Ananthakrishnan Subramaniam		13505 Edgetree Dr	13505 Edgetree Dr	Pineville NC 28134	L4 B1 M33-831	\$ 28.98
22301706	Musa Imreish	Sohaila Imreish	13515 Edgetree Dr	13515 Edgetree Dr	Pineville NC 28134	L3 B1 M33-831	\$ 28.98
22301707	Joel Dee Mcpherson	Tracy M Mcpherson	13525 Edgetree Dr	13525 Edgetree Dr	Pineville NC 28134	L2 B1 M33-831	\$ 28.98
22301708	Sharon E Ingram	Warren P Ingram	13531 Edgetree Dr	13531 Edgetree Dr	Pineville NC 28134	L1 B1 M33-831	\$ 28.98
22301709	Celia Houston Staples	Dennis Staples	13539 Edgetree Dr	13539 Edgetree Dr	Pineville NC 28134	L11 B1 M31-457	\$ 28.98
22301710	Steven G Mcatee	Pamela S Mcatee	13603 Edgetree Dr	13603 Edgetree Dr	Pineville NC 28134	L10 B1 M31-457	\$ 28.98
22301711	Christopher W Queen	Julie S Queen	13609 Edgetree Dr	13609 Edgetree Dr	Pineville NC 28134	L9 B1 M31-457	\$ 28.98
22301712	Mark S Westfall		13615 Edgetree Dr	13615 Edgetree Dr	Pineville NC 28134	L8 B1 M31-457	\$ 28.98
22301713	Calavin A Newell	Barbara A Newell	13621 Edgetree Dr	13621 Edgetree Dr	Pineville NC 28134	L7 B1 M29-596	\$ 28.98
22301714	William Cavanaugh	Lorrie Baines Cavanaugh	13629 Edgetree Dr	13629 Edgetree Dr	Pineville NC 28134	L6 B1 M29-596	\$ 28.98
22301715	Pamela S Kurpil		12544 Cardinal Woods Dr	12544 Cardinal Woods Dr	Pineville NC 28134	L5 B1 M29-596	\$ 28.98

**Cardinal Woods Subdivision and
Cardinal Woods Estate**
SL 98 - 04
Final
Assessment Roll for FY 2013

PARCEL	OWNER1	OWNER2	SITUS_ADDRESS	MAILING_ADDRESS	CITY_STATE	LEGAL_DESC	COST
22301716	Andrew M Ebneht	Monica L Ebneht	12538 Lancaster Hy	12538 Cardinal Woods Dr	Charlotte NC 28277	L4 B1 M29-596	\$ 28.98
22301717	Patricia Larocca		12532 Cardinal Woods Dr	9001 Twilight Hill Ct	Malibu CA 90265	L3 B1 M29-596	\$ 28.98
22301718	American Homes 4 Rent Properties		12526 Lancaster Hy	22917 Pacific Coast Hwy Ste 300	Pineville NC 28134	L2 B1 M29-596	\$ 28.98
22301719	Luis G Tovar	Elizabeth Tovar	12514 Cardinal Woods Dr	12514 Cardinal Woods Dr	Pineville, NC 28134	L1 B1 M29-596	\$ 28.98
						Sub Total:	\$5,135.14
22301329	David K James	Barbara G James	12649 Cardinal Woods Dr	12649 Cardinal Woods Dr	Pineville NC 28134	L29 B2 M33-905	\$83.35
22301330	Suedie J Lahoste		12653 Cardinal Woods Dr	12653 Cardinal Woods Dr	Charlotte NC 28134	L30 B2 M35-289	\$83.35
22301331	Diana Giel	Ryan Giel	12657 Cardinal Woods Dr	12657 Cardinal Woods Dr	Pineville NC 28134	L31 B2 M35-289	\$83.35
22301332	Peter A Cumming		12661 Cardinal Woods Dr	900 Riggins Rd Apt 912	Tallahassee FL 32308	L32 B2 M35-289	\$83.35
22301333	Cody R Rowe	Rebecca I Rowe	12670 Cardinal Woods Dr	12670 Cardinal Woods Dr	Pineville NC 28134	L33 B2 M35-289	\$83.35
22301334	James D Rogers	Palmer L Rogers	12666 Cardinal Woods Dr	12668 Cardinal Woods Dr	Pineville NC 28134	L34 B2 M33-905	\$83.35
22301335	Brendan M Shea	Celeste S Shea	12662 Cardinal Woods Dr	12662 Cardinal Woods Drive	Pineville NC 28134	L35 B2 M33-905	\$83.35
22301336	Rose Mary Leblanc		12658 Cardinal Woods Dr	12658 Cardinal Woods Dr	Pineville NC 28134	L36 B2 M33-905	\$83.35
22301337	Kevin E Adams	Ruth M Adams	12654 Cardinal Woods Dr	12654 Cardinal Woods Dr	Pineville NC 28134	L37 B2 M33-905	\$83.35
						Sub Total:	\$735.11
						Total:	\$5,870.25
Mecklenburg County North Carolina LUESA		Drawn by CS (September 20,2013) Checked by WDC Approved by WDC		Source: tax maps Tax records. Method:ACAD,digitizing		Cardinal Woods Subdivision and Cardinal Woods Estate SL 98-04 Street Lighting Assessment Project Final Assessment Roll Operation Costs FY 2013	

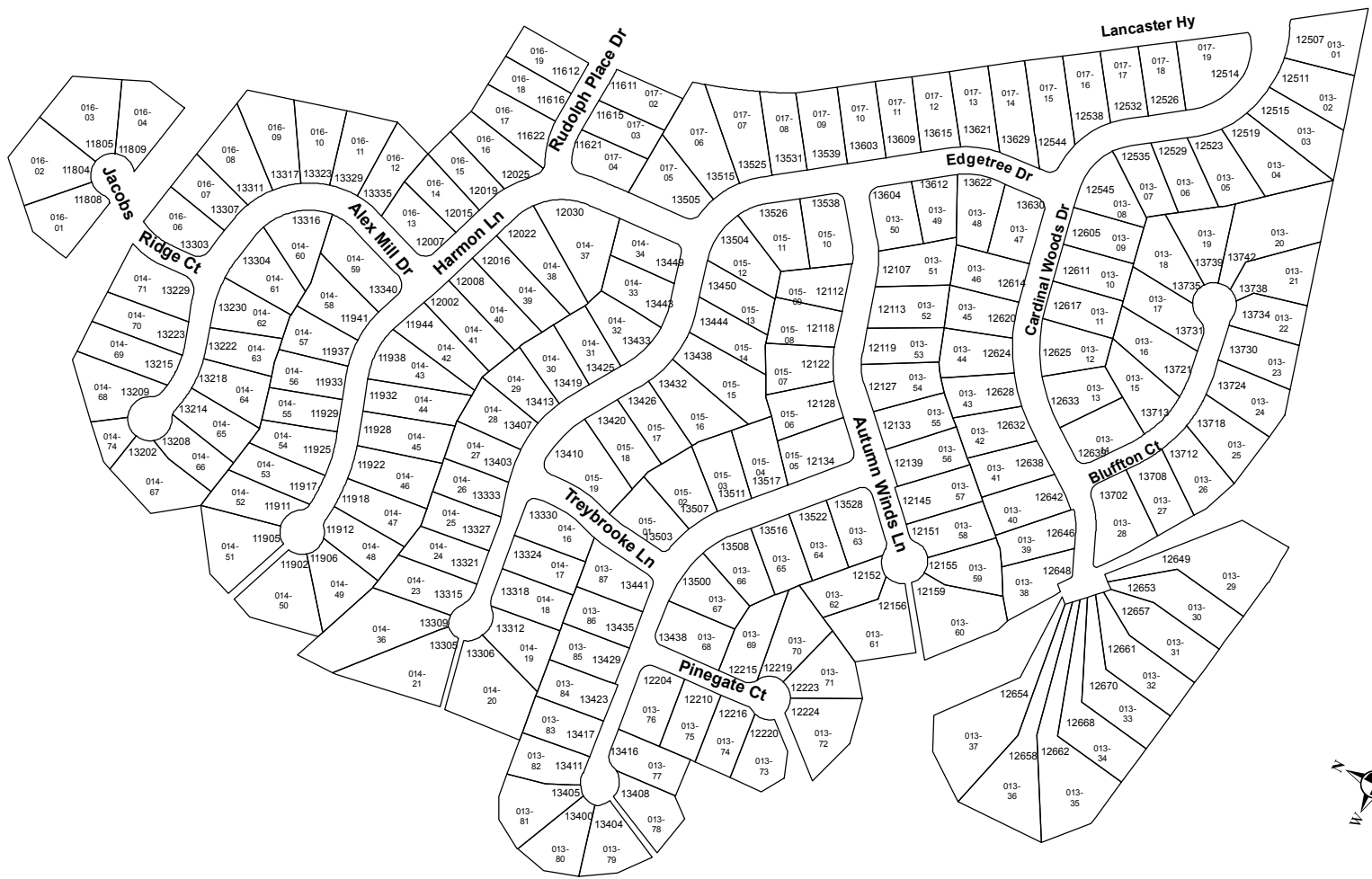

Mecklenburg County
 North Carolina
 LUESA

Drawn By KI (October 10, 2013)
 Checked by DC (October 10, 2013)
 Approved by DC (October 10, 2013)
 Page 1 of 1

Source: paper tax maps,
 tax records.
 Method: ArcMap, Digitizing

Cardinal Woods Subdivision and
 Cardinal Woods Estate
 SL 98 - 04
 Street Lighting Assessment Program
 Final Assessment Roll
 Operation Costs FY 2013